

190-935-190 44" Side Discharge Mowing Deck (1987)  
Deck Assembly

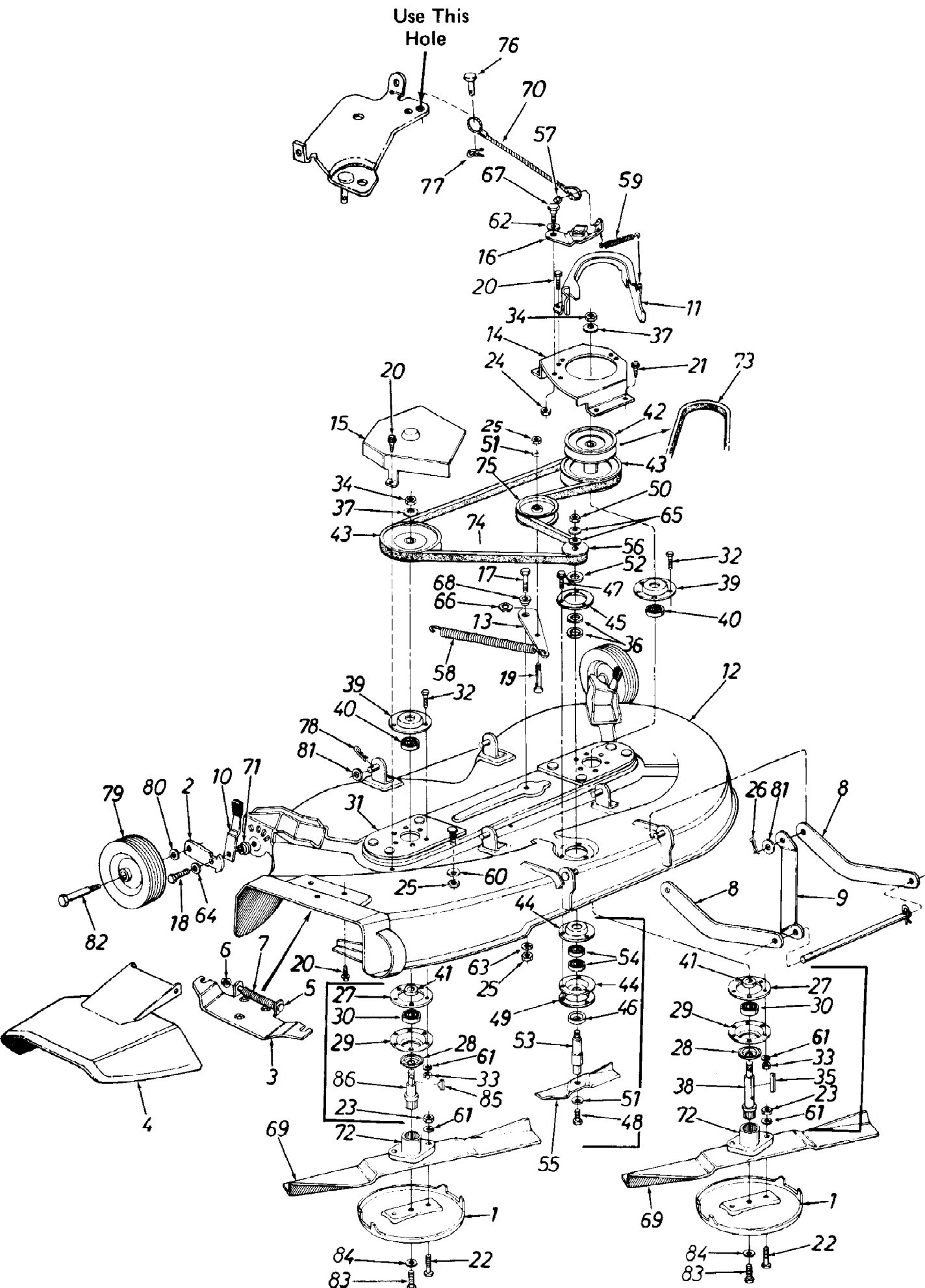

| Ref # | Part Number | Qty | S/P/F | Description                                |
|-------|-------------|-----|-------|--|
| 1     | 07919       | 1   | S     | Anti-Scalp Plate                           |
| 2     | 10937       | 1   |       | Wheel Pivot Bar                            |
| 3     | 11396       | 1   |       | Adapter                                    |
| 4     | 11574       | 1   |       | Chute Cover Ass'y.                         |
| 5     | 711-0571    | 1   |       | Hinge Pin                                  |
| 6     | 726-0106    | 1   | S     | Cap Speed Nut 1/4" Rod.                    |
| 7     | 732-0261    | 1   |       | Torsion Spring                             |
| 8     | 13866       | 1   |       | Deck Stabilizer                            |
| 9     | 13867       | 1   |       | Diagonal Brace                             |
| 10    | 14082       | 1   | /P    | Spring Lever Ass'y.                        |
| 11    | 14258       | 1   | S     | Belt Guard                                 |
| 12    | 16320       | 1   |       | 44" Deck Ass'y.                            |
| 13    | 16331       | 1   |       | Idler Bracket                              |
| 14    | 16333       | 1   |       | Pulley Cover L.H.                          |
| 15    | 16334       | 1   |       | Pulley Cover R.H.                          |
| 16    | 16339       | 1   |       | Spindle Brake Arm Ass'y.                   |
| 17    | 710-0152    | 1   | S     | Hex Bolt 3/8-24 x 1.00"*                   |
| 18    | 710-0191    | 1   | /P    | Hex Bolt 3/8-24 x 1.25" Lg.*               |
| 19    | 710-0459    | 1   | S     | Hex Bolt 3/8-24 x 1.50" *                  |
| 20    | 710-0599    | 1   | /P    | Hex Wash. S-Tapp Scr. 1/4-20 x .50"        |
| 21    | 710-0726    | 1   | /P    | Hex Wash. Hd. Tapp Scr. 5/16-18 x .75" Lg. |
| 22    | 710-0672    | 1   | /P    | Hex Bolt 5/16-24 x 1.25" (Grade 5)         |
| 23    | 712-0123    | 1   | /P    | Hex Nut 5/16-24 Thd.*                      |
| 24    | 712-0158    | 1   | S     | Hex Cent. L.-Nut 5/16-18 Thd.              |
| 25    | 712-0241    | 1   | /P    | Hex Nut 3/8-24 Thd.*                       |
| 26    | 714-0111    | 1   | S     | Cotter Pin 3/32 Dia. x 1.00" Lg. *         |
| 27    | 09164       | 1   | S     | Reinforcement Plate                        |
| 28    | 13703       | 1   |       | Bearing Shield                             |
| 29    | 15296       | 1   | S     | Open Brg. Housing 1.85 I.D.                |
| 30    | 741-0919    | 1   | S     | Ball Brg. .787 I.D. x 1.85 O.D. x .551     |
| 31    | 16349       | 1   |       | Spindle Mounting Plate Ass'y.              |
| 32    | 710-0888    | 1   | /P    | Hex Bolt 5/16-24 x 1.0"Lg. (Special)       |
| 33    | 712-0123    | 1   | /P    | Hex Nut-5/16-24                            |
| 34    | 712-0318    | 1   | /P    | Hex Jam Nut 5/8-18 Thd.                    |
| 35    | 714-0168    | 1   | /P    | Square Key 3/16 x 2.25"Lg.                 |
| 36    | 736-0302    | 1   | /P    | Fl. Wash. 5/8" I.D. x 15/16" O.D.          |
| 37    | 736-0317    | 1   | /P    | Bell. Wash. .630 I.D. x 1.25 O x .090      |
| 38    | 738-0632    | 1   | S     | 44" Deck Blade Spindle                     |
| 39    | 08253       | 1   | S     | Bearing Housing 1.85 I.D.                  |
| 40    | 741-0919    | 1   | S     | Ball. Brg. .787 I.D. x 1.85 O.D. x .551    |
| 41    | 750-0456    | 1   | S     | Spacer 1.0 O.D. x .790 I.D. x .350 Lg.     |
| 42    | 756-0329    | 1   |       | 5/8 "V"-Pulley .79 I.D. x 5.75 O.D.        |
| 43    | 756-0470    | 1   | S     | "V"-Pulley .79 I.D. x 6.50 O.D.            |
| 44    | 15319       | 1   | S     | 1-3/8" I.D.-Bearing Housinc                |
| 45    | 16348       | 1   | S     | Reinforcement Plate                        |
| 46    | 16400       | 1   |       | Bearing Shield                             |
| 47    | 710-0588    | 1   | S     | Hex "B" Tap Scr. .250" x 1.0" Lg.          |
| 48    | 710-0877    | 1   | S     | Hex Cl.-Scr. 3/8-24 x .88 Lg.              |
| 49    | 16348       | 1   | S     | Reinforcement Plate                        |
| 50    | 712-0922    | 1   | /P    | Hex Jam Nut 1/2-20 Thd.                    |
| 51    | 736-0105    | 1   | /P    | Bell.-Wash. .400 I.D. x .88 O.D. x .060    |
| 52    | 736-0162    | 1   | /P    | Fl.-Wash. .635 x 1.04 O.D. x .120"         |
| 53    | 738-0627    | 1   |       | Spindle                                    |

190-935-190 44" Side Discharge Mowing Deck (1987)  
Deck Assembly

Page 3 of 3

| Ref # | Part Number | Qty | S/P/F | Description  |
|-------|-------------|-----|-------|--|
| 54    | 741-0155    | 1   | S     | Ball Brg. .62 I.D. x 1.30" O.D. x .44"             |
| 55    | 742-0252    | 1   |       | 6.50" Blade  |
| 56    | 756-0468    | 1   |       | 1/2" V-Pulley Half .625 I.D. x 2.25" O.D.          |
| 57    | 726-0106    | 1   | S     | Cap Speed Nut 1/4" Rod.                            |
| 58    | 732-0121    | 1   | S     | Extension Spring .73 O.D. x 4.31 Lg.               |
| 59    | 732-0465    | 1   |       | Extension Spring .38 x 2.75" Lg.                   |
| 60    | 736-0105    | 1   | /P    | Bell.-Wash. .400 I.D. x .88 O.D. x .060            |
| 61    | 736-0119    | 1   | S     | L.-Wash. 5/16" I.D.*                               |
| 62    | 736-0141    | 1   | S     | Spring Wash. .445 I.D. x .75 O.D. x .017           |
| 63    |             | 1   |       | UNKNOWN  |
| 64    | 736-0219    | 1   | S     | Bell.-Wash. .400 I.D. x 1.13 O.D. x .030           |
| 65    | 736-0253    | 1   | S     | Bell.-Wash. .505 I.D. x 1.00 O.D. x .075           |
| 66    | 736-0174    | 1   | /P    | Spring Wash . .650 I.D. x .875 O.D. x .015<br>Thk. |
| 67    | 738-0140    | 1   | S     | Shld. Bolt .437 Dia. x .180                        |
| 68    | 738-0347    | 1   | S     | Shld. Spacer .625 I.D.                             |
| 69    | 742-0295    | 1   | S     | Mower Blade 21.88                                  |
| 70    | 746-0237    | 1   | S     | Brake Cable Ass'y.                                 |
| 71    | 748-0279    | 1   |       | Shld. Spacer                                       |
| 72    | 748-0300    | 1   |       | Blade Adapter                                      |
| 73    | 754-0230    | 1   | S     | "V"-Belt 1/2 x 56 " Lg.                            |
| 74    | 754-0293    | 1   | S     | "V"-Belt 1/2 x 74" Lg. (Drive Belt)                |
| 75    | 756-0365    | 1   | S     | Fl.-Idler w/Flanges 3.50 O.D.                      |
| 76    | 711-0701    | 1   | S     | Clevis Pin 1/4 Dia. x .53 Lg.                      |
| 77    | 714-0104    | 1   | S     | Intern. Cotter Pin 5/16" Dia.                      |
| 78    | 714-0145    | 1   | S     | Intern. Cotter Pin 1/2" Dia.                       |
| 79    | 734-0974    | 1   | /P    | Deck Wheel 6.0 x 1.38                              |
| 80    | 736-0105    | 1   | /P    | Bell.-Wash. .400 I.D. x .88 O.D. x .060            |
| 81    | 736-0192    | 1   | S     | Fl.-Wash. .531 I.D. x .93 O.D. x .090              |
| 82    | 738-0455    | 1   | S     | Shoulder Bolt 3/8-16 x 1.41                        |
| 83    | 710-0877    | 1   | S     | Hex Bolt 3/8-24 x .88" Lg. (Special)               |
| 84    | 736-0169    | 1   | S     | L.-Washer 3/8 I.D.*                                |
| 85    | 714-0122    | 1   | S     | Sq. Key 3/16 x .75" Lg.                            |
| 86    | 738-0633    | 1   | S     | 44" Deck Blade Spindle                             |
|       | 917-0910    | 1   | /P    | R.H. Spindle Ass'y.                                |
|       | 717-0619    | 1   |       | Center Spindle Ass'y.                              |
|       | 917-0909    | 1   | /P    | L.H. Spindle Ass'y.                                |